

Construction Design and Management Regulations
 Design team assessments are carried out throughout the design stages of the project in accordance with company procedures and research. They necessarily provide an overview of the applicable design and not one of the construction details. These assessments are not intended to be a substitute for a detailed design. The design team will be responsible for the design and construction of the project. The design team will be responsible for the design and construction of the project. The design team will be responsible for the design and construction of the project.

- Proposed Planning Boundary
- Other Land Under the Control of the Applicant
- Indicative Underground Cable Route
- FULL PLANNING AREA

No.	Unit Name
23	National Grid Compound
24	Incoming Scrap Yard Electrical Building
25	Scrap Storage & Processing Yard
26	Overflow Scrapyard
27	Non Ferrous Processing Area
28	Scanning Facilities
29	Railway Weigh Bridge

Outline Scrap - Phase 2		Minimum Dimensions		
Name	Category	L	W	H
National Grid Compound	P	200m	100m	15m
Incoming Scrap Yard Electrical Building	B	30m	25m	8m
Office	B	40m	20m	8m
Car Park	E	25m	25m	0m
Disabled Car Park	E	3.6m	1.5m	0m
Workshop	B	70m	25m	8m
Scrap Storage	E	variable	variable	7m
Pile-Shredder Feed Stock Pile	E	25m	20m	6m
Pile-Shredder	P	12m	11.3m	9m
Shredder Feed Stock Pile	E	62m	32m	9m
Shredder (Block 01 - Infeed Conveyor)	B	30m	10m	10m
Shredder (Block 02 - Hammer Mill)	B	40m	40m	20m
Shredder (Block 03 - Air Separation)	B	25m	125m	20m
Shredder (Block 04 - Picking & Stacking)	B	60m	125m	20m
Acoustic Mitigation Barrier	B	800m	5m	15m
Lorry Tipping Area	E	150m	50m	7m
HARSCO Shredder	P	50m	50m	7m
Shear	P	58.7m	53m	7m
Overflow Scrap Bay 01	E	50m	100m	7m
Overflow Scrap Bay 02	E	60m	60m	7m
Existing Reprocessed Building	B	115m	65m	15m
Non Ferrous Processing Area	E	67m	125m	13m
Scanning Facilities	B	15m	15m	15m
Railway Weigh Bridge	B	15m	15m	15m

Minimum building dimensions to be 0m to indicate not constructing

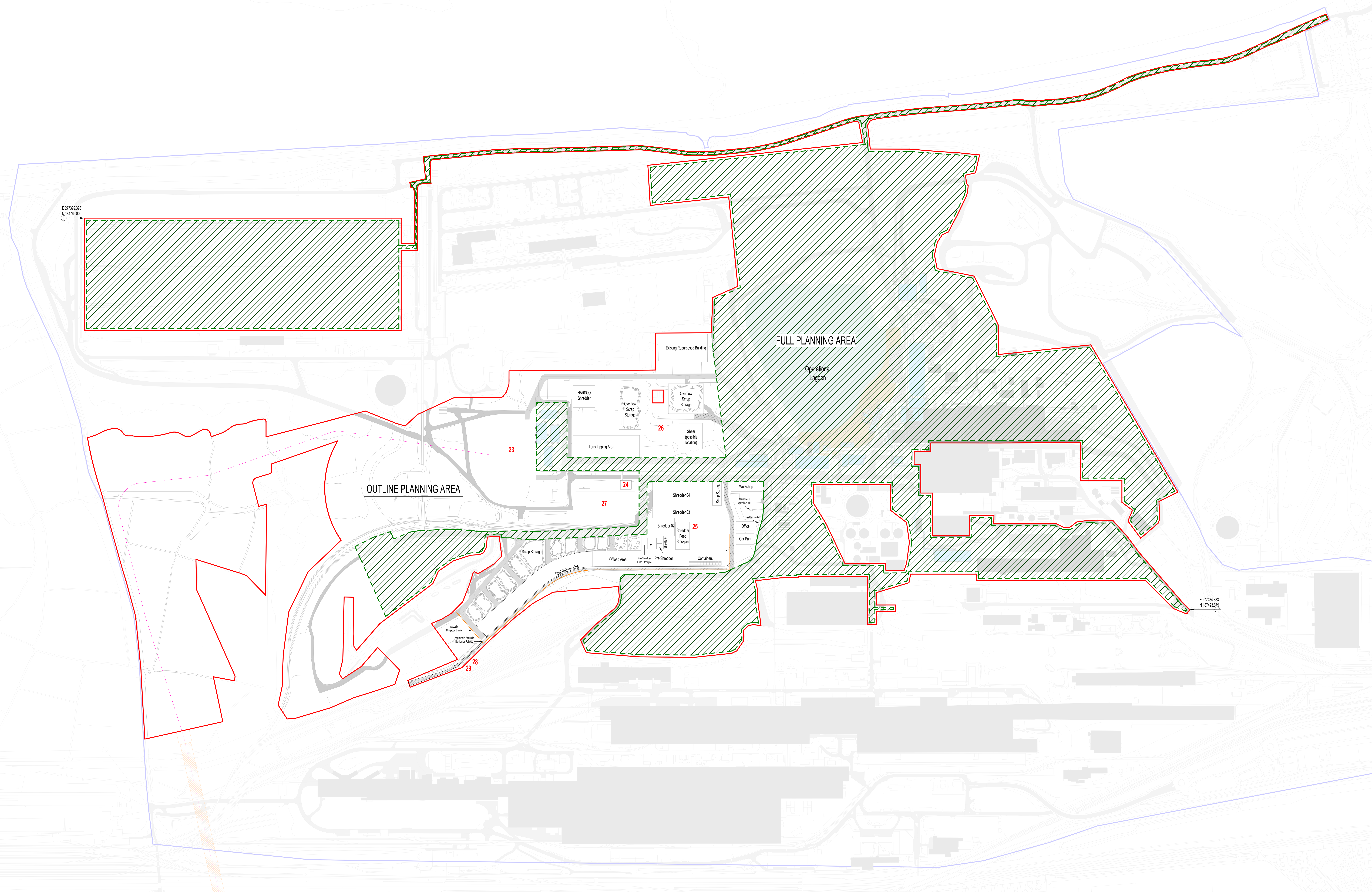

REV	DESCRIPTION	DRAWN BY	CHECKED BY	APPROVED BY	DATE
P05	Updated following NPT comments				05/06/2024
P04	Issue to NPT				23/06/2024
P03	Revised Boundary following Client Comments				14/06/2024
P02	Update following comments from Planning				15/07/2024
P01	Planning Issue				27/06/2024
P00	Initial Issue				20/06/2024



CARDIFF 029 2052 8140
 LONDON 0207 136 3660
 WREXHAM 01978 357 887
 www.lawray.co.uk

CLIENT
 Tata Steel UK Ltd.

PROJECT TITLE
 EAF PROJECT, PORT TALBOT

PROJECT No.	SCALE @ A0
20007	As indicated
DRAWING No.	Revision
EAF-LAW-X-DR-A-900010	P05