

Construction (Design and Management) Regulations
 Design risk assessments are carried out throughout the design stage of this project in accordance with company procedures and manuals. Where reasonably possible all areas of risk applicable to design and end use of the construction have been identified and then eliminated, mitigated or recorded as a residual risk. Note that general risks of which a competent designer or contractor should be aware are not included. This drawing to be used in conjunction with the Pre-construction Information and all related documents prepared in accordance with the current Construction (Design and Management) Regulations 2015 and all applicable Health and Safety legislation as currently amended.

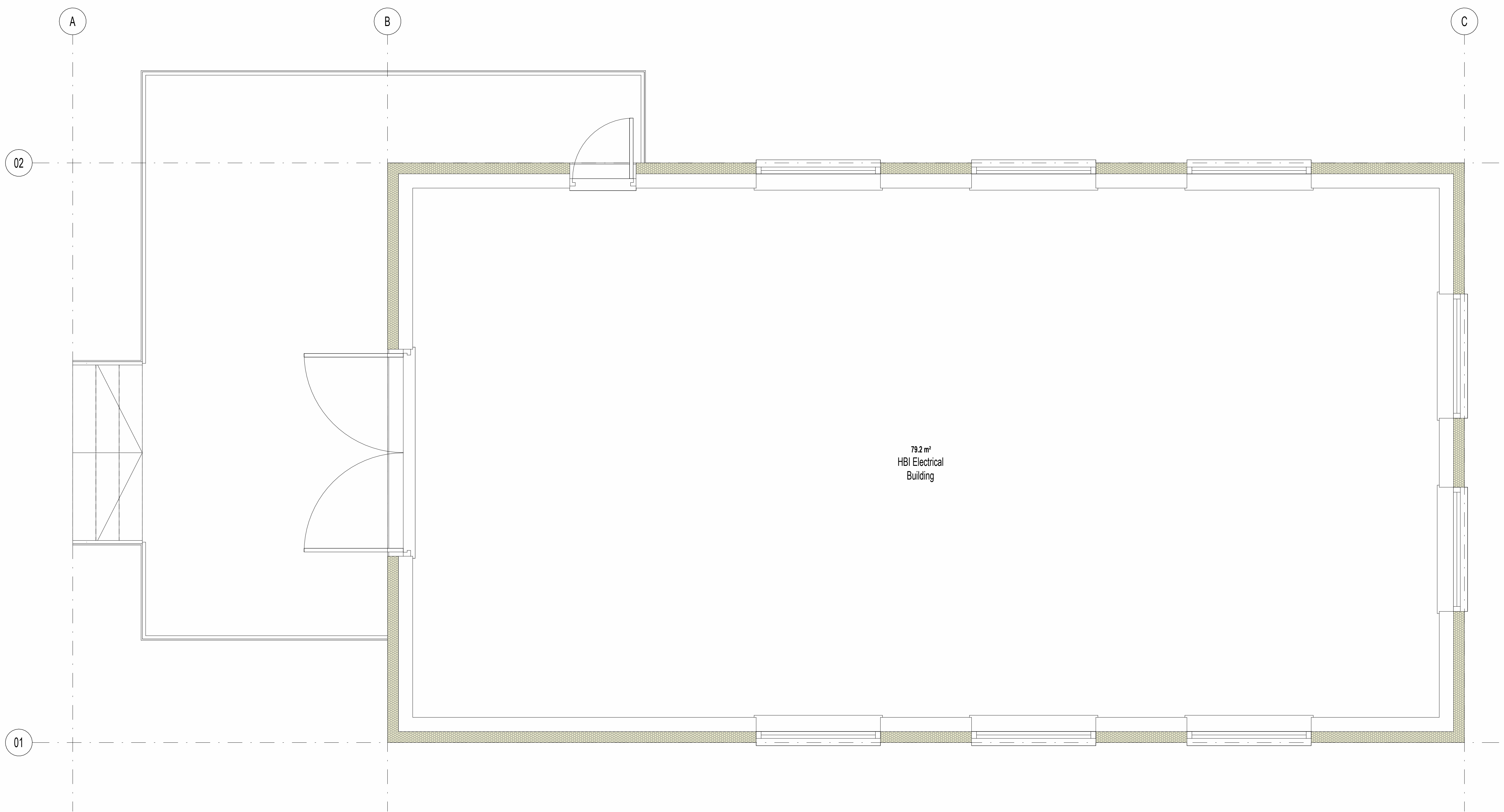

P01 - Updated following NPT comments	05/09/2024
P00 - Issue to NPT	23/08/2024
REV. DESCRIPTION DRAWN BY CHECKED BY APPROVED BY DATE	
RIBA PLAN OF WORK WORKSTAGE	LEVEL OF MODEL DEFINITION (LoD)
Stage 3 - Spatial Coordination	LoD 3 - Approximate Model
PURPOSE OF ISSUE - SUITABLE FOR...	STATUS or SUITABILITY
Planning Submission	Status S2 - Delivery Team Information

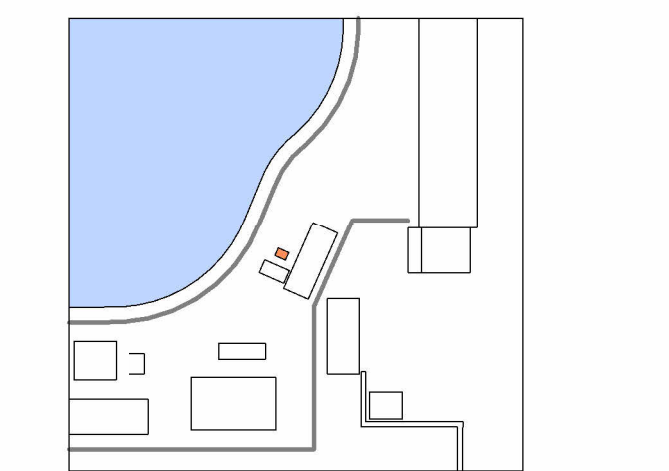
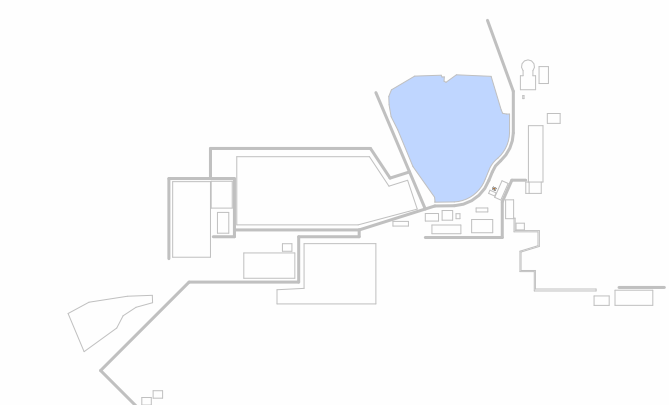

CARDIFF 029 2052 8140
 LONDON 0207 138 3560
 WREXHAM 01978 357 887
 www.lawray.co.uk
 CLIENT
 Tata Steel UK Ltd.

PROJECT TITLE
 EAF PROJECT, PORT TALBOT

DRAWING TITLE
 Unit 32 - HBI Electrical Building - Proposed Ground Floorplan

PROJECT No 20007 SCALE @ A1 As indicated

DRAWING No	1100 - Project Originator	Issue	Level	Type	Size	Number	REVISION
1800 - Project Originator	Functional	Spatial	Form	Discipline	Number	Revision	
42-2018-18	EAF-LAW-32-X-DR-A-061001						P01

DO NOT SCALE Any discrepancy or query concerning this drawing should be referred to the Architect.
 Registered Office: Greenmeadow Springs, 1, Cae Gwynedd, Tŷgwynnias, CARDIFF CF15 7AB
 Reg. Co. No. 272417E, VAT Reg. No. 154 2146 06

G00 - Proposed Ground
 1 : 25