

Construction (Design and Management) Regulations
 Design risk assessments are carried out throughout the design stages of this project in accordance with company procedures and manuals. Where reasonably possible all areas of risk applicable to design and use of the construction have been identified and then eliminated, mitigated or recorded as a residual risk. Note that general risks of which a competent designer or contractor should be aware are not included. This drawing is to be read in conjunction with the Pre-construction Information and all related documents prepared in accordance with the current Construction (Design and Management) Regulations 2015 and all applicable Health and Safety legislation as currently amended.

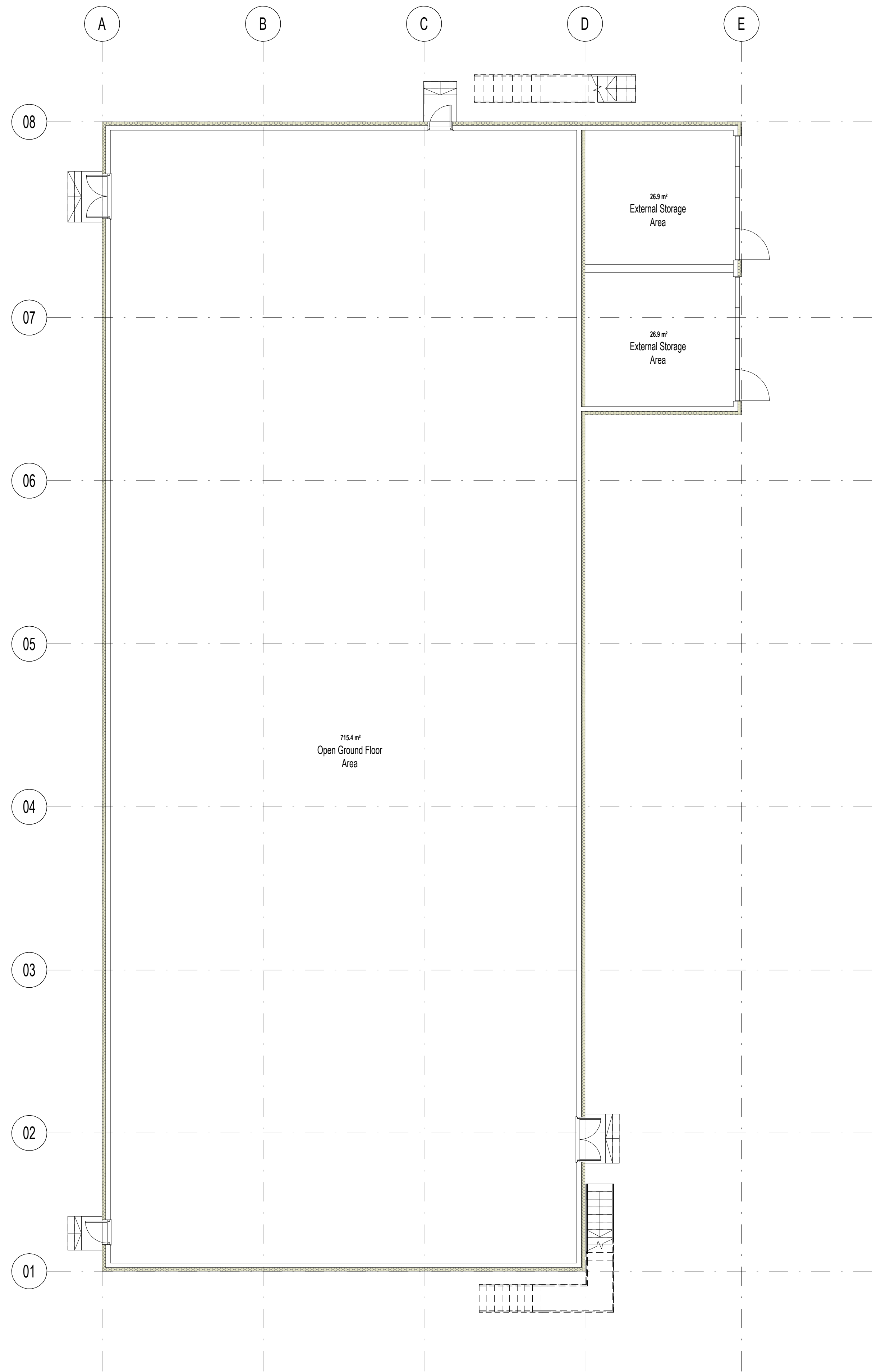

G00 - Proposed Ground Floor Plan
 1 : 100

P01	Updated following NPT comments	05/09/2024
P00	Issue to NPT	23/08/2024
REV	DESCRIPTION DRAWN BY CHECKED BY APPROVED BY	DATE
	RIBA PLAN OF WORK WORKSTAGE	LEVEL OF MODEL DEFINITION (LoD)
	Stage 3 - Spatial Coordination	LoD 3 - Approximate Model
PURPOSE OF ISSUE - SUITABLE FOR ...	STATUS or SUITABILITY	
Planning Submission	Status S2 - Delivery Team Information	



CARDIFF 029 2052 8140
 LONDON 0207 138 3660
 WREXHAM 01978 357 887
www.lawray.co.uk
 CLIENT
 Tata Steel UK Ltd.

PROJECT TITLE
 EAF PROJECT, PORT TALBOT

DRAWING TITLE
 Unit 21 - Main Power Centre - Proposed Ground Floor Plan

PROJECT No
 20007
 SCALE @ A1
 As indicated

DRAWING No	1102	Project	Originator	Version	Level	Type	Scale	Number	REVISION
	1811/2/2017				Functional	Spatial	Form	Discipline	
	+12/21/18								
	18/10/2019/1800	EAF-LAW-21-G00-DR-A-061001							P01

DO NOT SCALE
 Any discrepancy or query concerning this drawing should be referred to the Architect
 Copyright © LAWRAY LIMITED
 Registered Office: Greenmeadow Springs, 1 Oak Grove, Torquayville, CARDIFF CF15 7AB
 Reg. Co. No. 2724178. VAT Reg. No. 134 2148 06