

Construction (Design and Management) Regulations
 Design risk assessments are carried out throughout the design stage of this project in accordance with company procedures and manuals. Where reasonably possible all areas of risk applicable to design and end use of the construction have been identified and then eliminated, mitigated or recorded as a residual risk. Note that general risks of which a competent designer or contractor should be aware are not included. This drawing is to be read in conjunction with the Pre-construction Information and all related documents prepared in accordance with the current Construction (Design and Management) Regulations 2015 and all applicable Health and Safety legislation as currently amended.

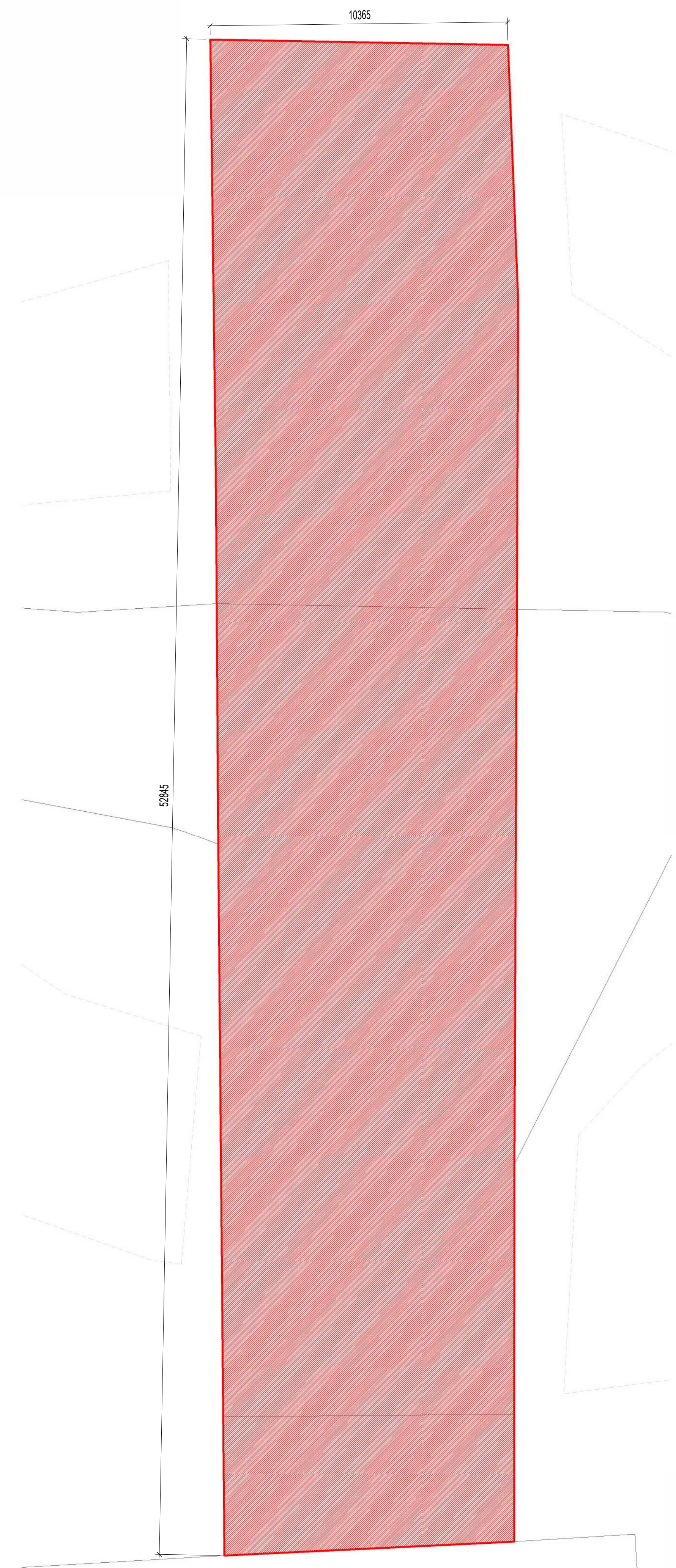

1 Demolition Plan - 1R Concrete Abutments
 1:100

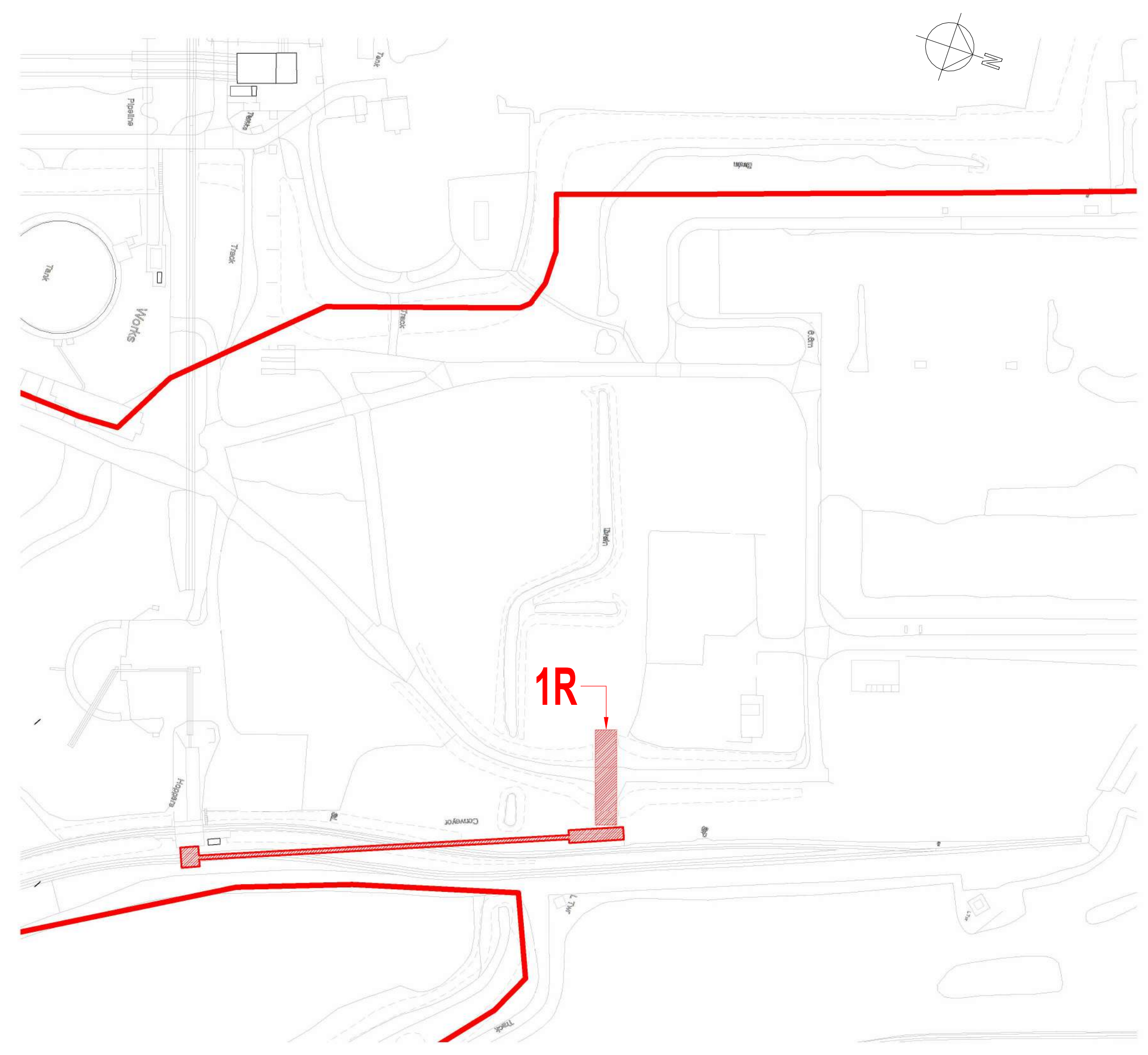

2 Demolition Site Plan - 1R Concrete Abutments
 1:2000



Photo 1 - Concrete Abutments



Photo 2 - Concrete Abutments



Photo 5 - Concrete Abutments

P01 Updated following NPT comments	05/09/2024
P00 Issued for comment	21/08/2024
REV DESCRIPTION DRAWN BY CHECKED BY APPROVED BY	DATE
RIBA PLAN OF WORK 2013 WORKSTAGE	LEVEL OF MODEL DEFINITION (LoD)
Stage 3 - Spatial Coordination	LoD 3 - Approximate Model
PURPOSE OF ISSUE - SUITABLE FOR ...	BS1192:4+1:2015
Planning Submission	SEALS:2 - Information

Turley

lawray architects

CARDIFF 029 2052 8140
 LONDON 0207 138 3560
 WREXHAM 01978 357 887
 www.lawray.co.uk
 CLIENT
 TURLEY

PROJECT TITLE
 PROJECT CRONUS, PORT TALBOT

DRAWING TITLE
 Demolition - 1R Concrete Abutments

PROJECT No
 19593

DRAWING No	1100 Project Originator	Issue	Level	Type	Scale	Number	REVISION
BS1192:2015	1900 Project Originator	Functional	Spatial	Form	Discipline	Number	
+422018	BS1192:2015	BS1192:2015	BS1192:2015	BS1192:2015	BS1192:2015	BS1192:2015	
19593	19593	19593	19593	19593	19593	19593	
	EAFLAW-1R-X-DR	A-040019					P01

DO NOT SCALE Any discrepancy or query concerning this drawing should be referred to the Architect.
 Registered Office: Greenmeadow Springs, 1 Cae Gwynedd, Trefyniwl, CARDIFF CF15 7AB
 Reg. Co. No. 272417E, VAT Reg. No. 154 2146 06