

Construction (Design and Management) Regulations
 Design risk assessments are carried out throughout the design stages of this project in accordance with company procedures and manuals. Where reasonably possible all areas of risk applicable to design and use of the construction have been identified and then eliminated, mitigated or recorded as a residual risk. Note that general risks of which a competent designer or contractor should be aware are not included. This drawing to be read in conjunction with the Pre-construction Information and all related documents prepared in accordance with the current Construction (Design and Management) Regulations 2015 and all applicable Health and Safety legislation as currently amended.

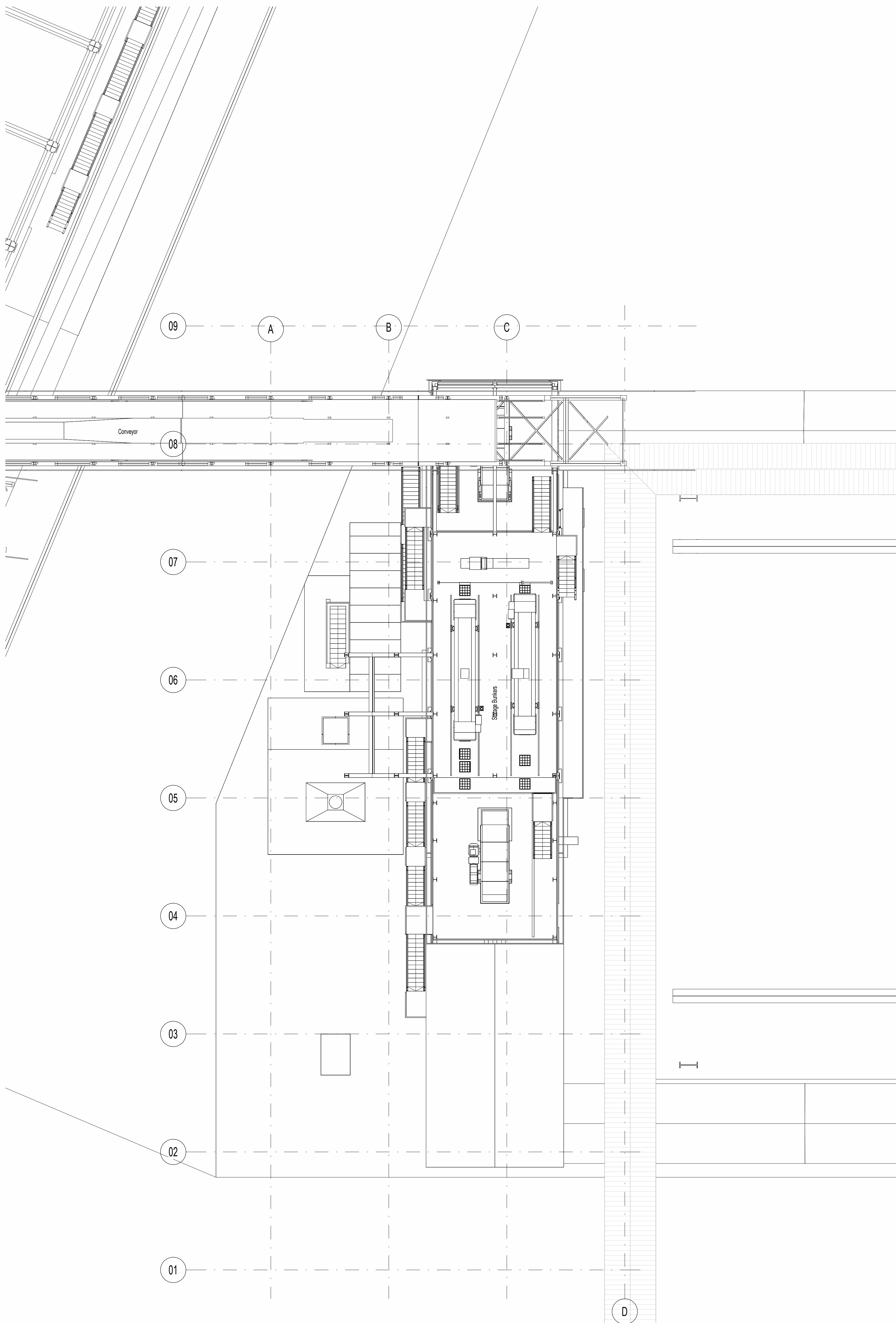

G00 - Proposed Upper Floors Plan
 1: 100

P01 Updated following NPT comments	05/09/2024
P00 Issue to NPT	23/08/2024
REV DESCRIPTION DRAWN BY CHECKED BY APPROVED BY	DATE
RIBA PLAN OF WORK WORKSTAGE	LEVEL OF MODEL DEFINITION (LoD)
Stage 3 - Spatial Coordination	LoD 3 - Approximate Model
PURPOSE OF ISSUE - SUITABLE FOR ...	STATUS or SUITABILITY
Planning Submission	Status S2 - Delivery Team Information

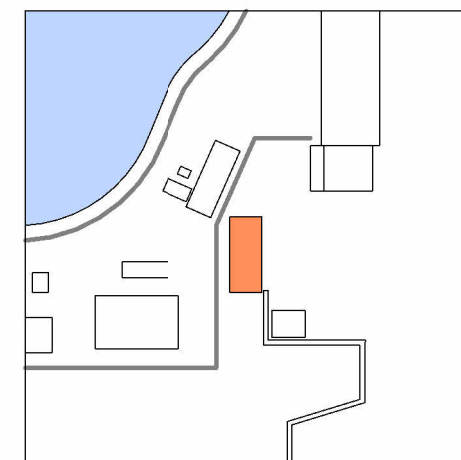
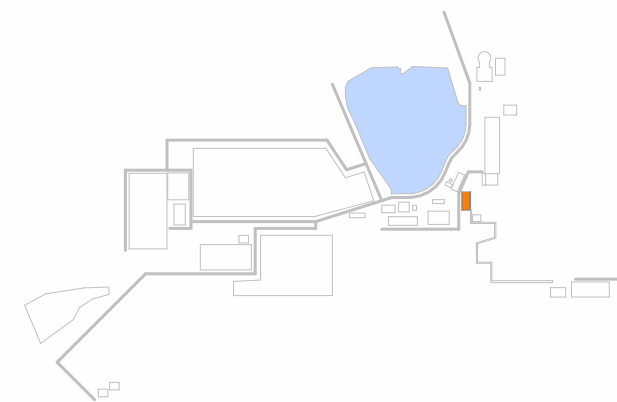

CARDIFF 029 2052 8140
 LONDON 0207 138 3560
 WREXHAM 01978 357 887
www.lawray.co.uk
 CLIENT
 Tata Steel UK Ltd.

PROJECT TITLE
 EAF PROJECT, PORT TALBOT

DRAWING TITLE
 Unit 06 - Ferro Alloys Bunker - Proposed First Floor Plan

PROJECT No 20007 SCALE @ A1 As indicated

DRAWING No 1817/02/01	1102 Project - Originator - Volume - Level - Type - Risk - Number	REVISION
+12/2018.8	1900 Project - Originator - Functional - Spatial - Form - Discipline - Number	
18/10/2018/001	EAFLAW-06-U01-DR-A-061002	P01

DO NOT SCALE Any discrepancy or query concerning this drawing should be referred to the Architect
 Registered Office: Greenmeadow Springs, 1 Can Gwynn, Tregynon, CARDIFF CF15 7AB
 Reg. No. 272478. VAT Reg. No. 134 2148 06