



STEPHENSON
HALLIDAY

Planning, Landscape & Environment
an **RSK** company

PORT TALBOT: P FIELDS

Landscape Strategy

Tata Steel UK Ltd

August 2024

Rev P02



Contents

Landscape Strategy – Page 2

Appendices

Appendix 1: Landscape Mitigation Site Plan

Document history

	Name	Date
Author	Hannah Low	17/07/2024
Approved	Dan Leaver	17/07/2024

Revisions

Rev 01 – Amendments to site layout – 02.05.2024 (AH/DL)

Rev 02 – Updated Landscape Mitigation Plan to reflect further amendments to site layout – 05.08.2024 (HL/DL)

LANDSCAPE STRATEGY

The P Fields application area offers little in term of existing Green Infrastructure as the site is largely made up of degraded hard standing, compacted rough and potentially contaminated ground and, spoil heaps generated from waste products associated with the steel manufacturing processes on site. However, within the redline boundary, there are significant spoil heaps covered with open grass mosaic habitat that has self-colonised over the years.

The largest heap occupies the north-western corner and extends in a thin linear strip diagonally southwards. Within the redline boundary this covers an area of approximately 7000m² of which 6000m² is proposed for removal and stored for future projects. Two smaller spoil heaps are located to the south and straddle the red line boundary. These too, are covered in open grass mosaic habitat. Only a small area of approximately 90m² is proposed for removal within the redline boundary.

The open grass mosaic is a key habitat found in this industrial setting and is present on multiple spoil heaps across the wider TATA operational site. Stephenson Halliday has been directly involved in detailed discussion on other development proposals on the steelworks site in recent years. Many of the discussions have involved the most appropriate means of mitigating and enhancing in response to development on open mosaic habitat. The outcomes of these discussions are relevant to the proposed development.

The proposed development includes provision to support a wider landscape and ecology mitigation strategy being discussed at the steelworks.

Excess spoil and soil excavated from the application site will be relocated around the site as mounds and bunds, preserving the seed bank and expanding the mosaic grass habitat cross the wider steelworks site. These new mounds will be untreated and left as bare earth features allowing self-colonisation to take place to replicate the spoil heaps across the wider site. The newly formed spoil or soil mounds will not be seeded with any commercial seed mix, allowing the existing seed bank to thrive.

As the spoil heap cannot be retained on site due to the development proposals, removing it and setting it aside for placement elsewhere on the steelworks in agreement with officers at Neath Port Talbot Council is considered the most appropriate form of mitigation and enhancement available. This process will enable the retention of the existing seed bank thus not removing or reducing any GI from the wider site.





Appropriate locations for the P Fields spoil will be identified in collaboration with the Council during the determination of the application and/or via an appropriately worded planning condition. The proposed locations include:

- To fill gabion baskets with a mix of site spoil from P Fields to form modular biodiversity baskets.
- To create some roadside bunds to provide some mitigation to road verges preventing damage from site vehicles. There is precedent for this within the wider operational area and this will further expand the open grass mosaic across the site.
- To create open mosaic scrapes in suitable locations across the steelworks site and on land controlled by Tata Steel Uk.

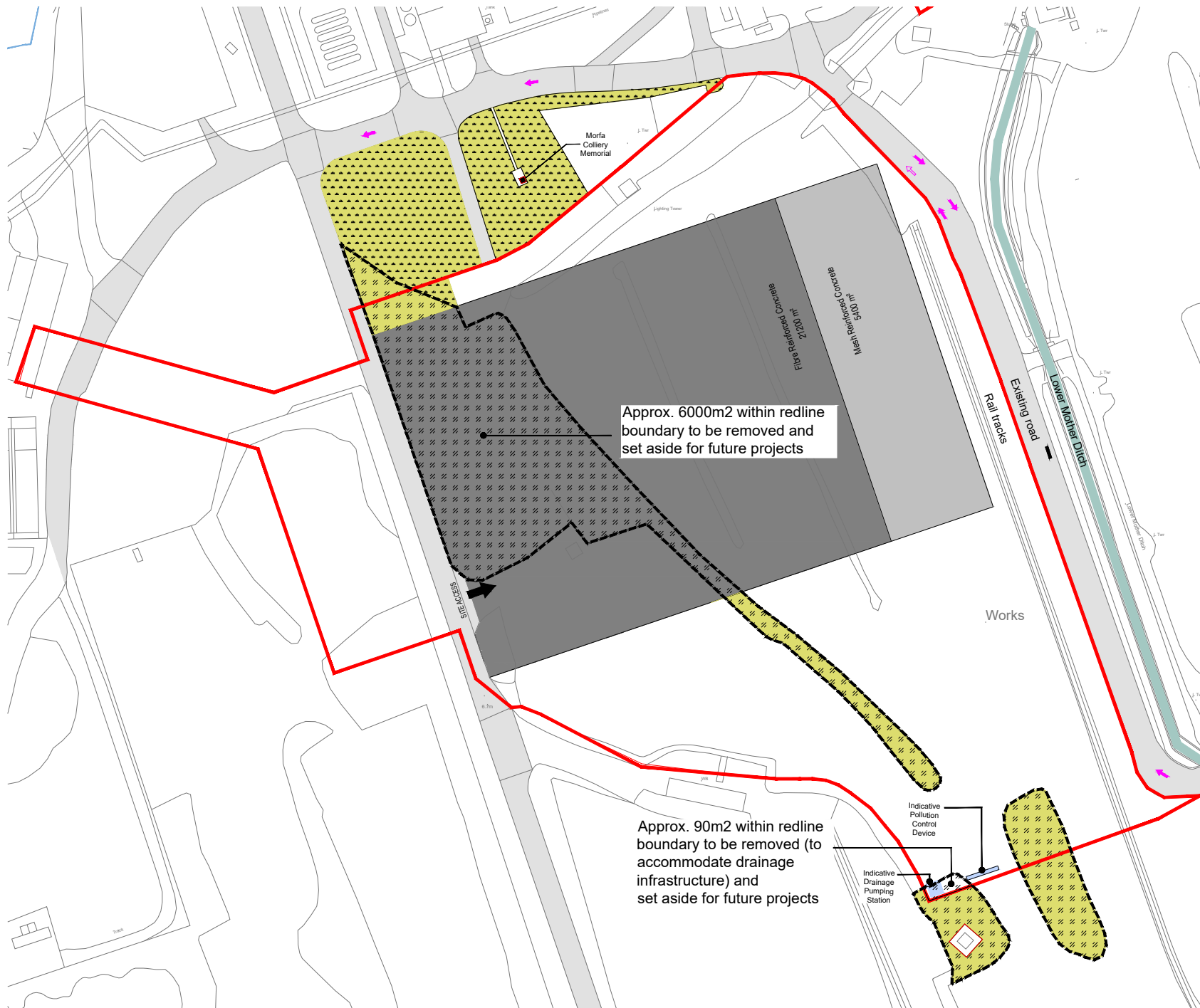
The proposed approach will relocate the excavated material and the associated seed bank successfully within the wider steelworks. Its targeted relocation in consultation with officers at the Council will deliver appropriate enhancement. This is particularly the case when the material is included in a programme of targeted re-greening and biodiversity enhancement across the steelworks.

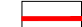
Refer to Appendix 1- Landscape Mitigation Plan

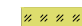
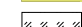

-  Application boundary
-  Existing managed / mown grassland retained
-  Approximate extent of existing spoil heaps with open grass mosaic habitat
-  Approximate extent of existing spoil heaps with open grass mosaic habitat to be retained
-  Approximate extent of existing spoil heaps with open grass mosaic to be removed and set aside for future projects
-  Extent of new concrete base
Refer to architects drawings:
EAF-LAW-P-X-DR-A-90101_P02 to
EAF-LAW-P-X-DR-A-90105_P02
for details



Project: P Fields, Port Talbot
 Client: Tata Steel
 Drawing: Landscape Mitigation
 Scale: 1:2000 @ A4
 Rev: P02